

SMT630W-23

High Performance Red Color TOP LED with Lens

SMT630W-23 consists of an AlGaInP LED mounted on the lead frame as TOP LED package with plastic ball lens. It is 1500mcd typical of Brightness. It emits a spectral band of radiation at 635nm.

<Specifications>

1. Product Name: TOP LED
2. Type Number: SMT630W-23
3. Chip:
 - Chip Material: AlGaInP
 - Peak Wavelength: 635nm
4. Package
 - Lead Frame Die: Silver Plated
 - Package Resin: PPA Resin
 - Lens: Epoxy Resin

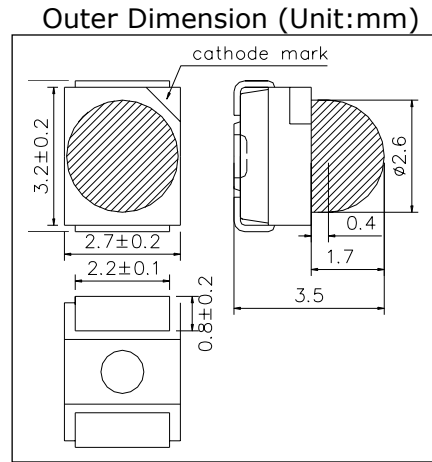

Absolute Maximum Ratings[Ta=25°C]			
Item	Symbol	Maximum Rated Value	Unit
Power Dissipation	PD	140	mW
Forward Current	IF	40	mA
Pulse Forward Current*	IFP	200	mA
Reverse Voltage	VR	5	V
Operating Temperature	TOPR	-20 ~ +80	°C
Storage Temperature	TSTG	-30 ~ +80	°C
Soldering Temperature**	TSOL	255	°C

* Duty=1% and Pulse Width=10us.

** Soldering condition must be completed within 10 second at 255 °C.

Electro-Optical Characteristics[Ta=25°C]						
Item	Symbol	Condition	Minimum	Typical	Maximum	Unit
Forward Voltage	VF	IF=20mA		2.2	2.6	V
Reverse Current	IR	VR=5V			10	uA
Total Radiated Power*	PO	IF=20mA	4.0	7.5		mW
Brightness	IV	IF=20mA		1500		mcd
Radiant Intensity**	IE	IF=20mA	6.0	10.0		mW/sr
Peak Wavelength	λP	IF=20mA	630	635	640	nm
Half Width	$\Delta\lambda$	IF=20mA		20		nm
Viewing Half Angle	$\theta 1/2$	IF=20mA		± 20		deg

* Measured by Photodyne #500

** Measured by Tektronix J-6512



◆ SMD Application
Recommended reflow soldering profile

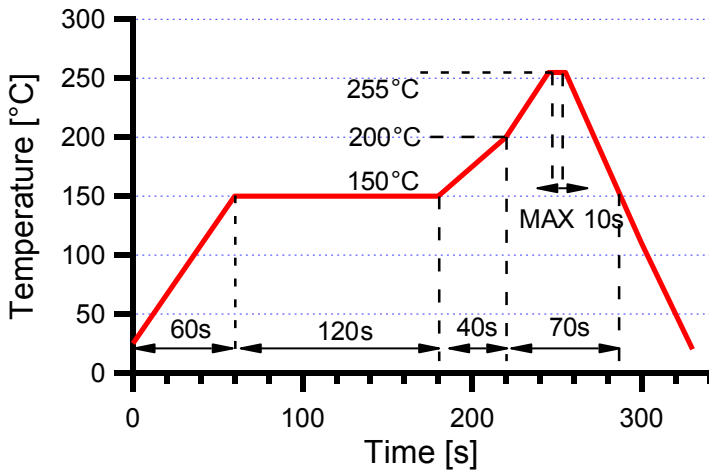

Recommended Land Layout (Unit: mm)

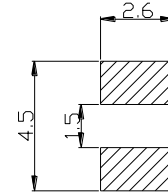

Don't put stress on SMD and a circuit board after soldering.

◆ SMD Packing
Tape and Reel Dimensions (Unit: mm)

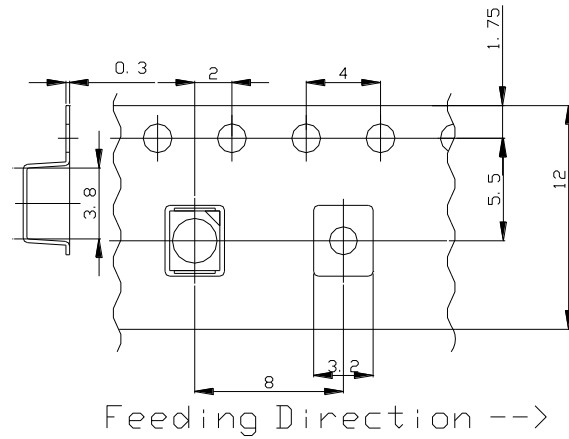
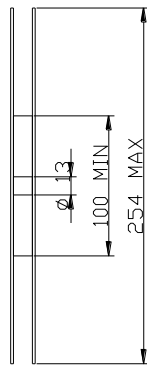
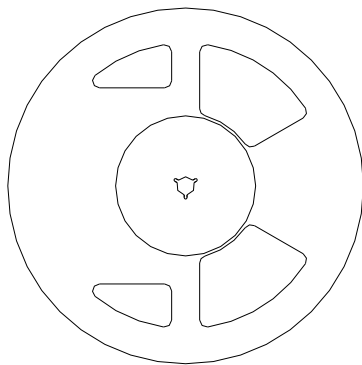

◆ Wrapping

Moisture barrier bag aluminum laminated film with a desiccant to keep out the moisture absorption during the transportation and storage.